

# POINTED BUTTON TOOLING PINS FOR BARE BOARD FIXTURES

## STANDARD

### POINTED BUTTON TOOLING PINS

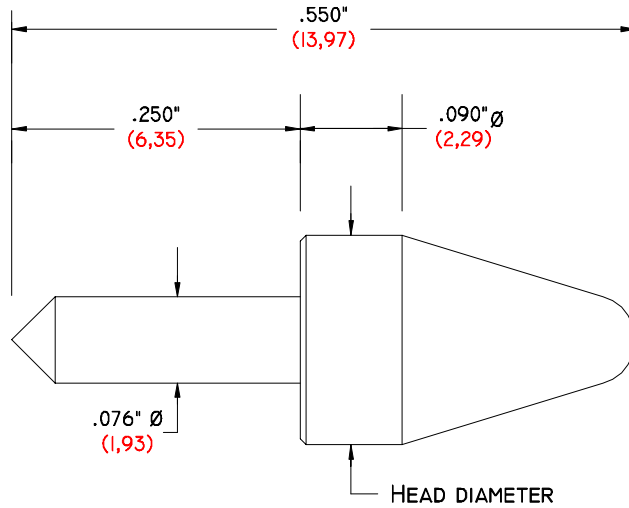

STANDARD HEAD DIAMETERS
.095" (2,41)
.109" (2,77)
.124" (3,15)
.135" (3,43)
.155" (3,94)
.185" (4,70)
.250" (6,35)

TO ORDER, DEVELOP A PART NUMBER BY SELECTING A STANDARD HEAD DIAMETER FROM THE TABLE AT RIGHT.

EXAMPLE:

GI- 550 - **095** PBTP

— HEAD DIAMETER

MATERIAL: STAINLESS STEEL.

## CUSTOM

### POINTED BUTTON TOOLING PINS

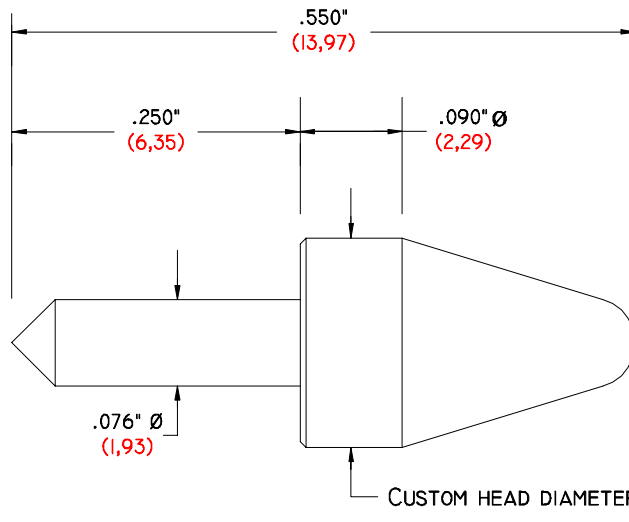

CUSTOM HEAD DIAMETER- .076" (1,93) MINIMUM  
.250" (6,35) MAXIMUM

TO ORDER, DEVELOP A PART NUMBER USING THE CUSTOM HEAD DIAMETER REQUIRED FROM .076" (1,93) MINIMUM, TO .250" (6,35) MAXIMUM IN .001" (0,025) STEPS.

EXAMPLE:

GI- 550 - **143** PBTP

— HEAD DIAMETER

MATERIAL: STAINLESS STEEL.