

# BUTTON TOOLING PINS FOR BARE BOARD FIXTURES

## STANDARD BUTTON TOOLING PINS

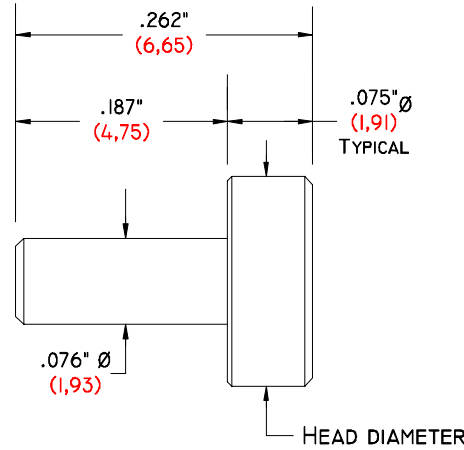

STANDARD HEAD DIAMETERS	
.095"	(2,41)
.109"	(2,77)
.124"	(3,15)
.135"	(3,43)
.155"	(3,94)
.185"	(4,70)
.250"	(6,35)

TO ORDER, DEVELOP A PART NUMBER BY SELECTING A STANDARD HEAD DIAMETER FROM THE TABLE AT RIGHT.

EXAMPLE:

GI- 262 - 095 BTP

HEAD DIAMETER

MATERIAL: STAINLESS STEEL.

## CUSTOM BUTTON TOOLING PINS

### LIP STYLE

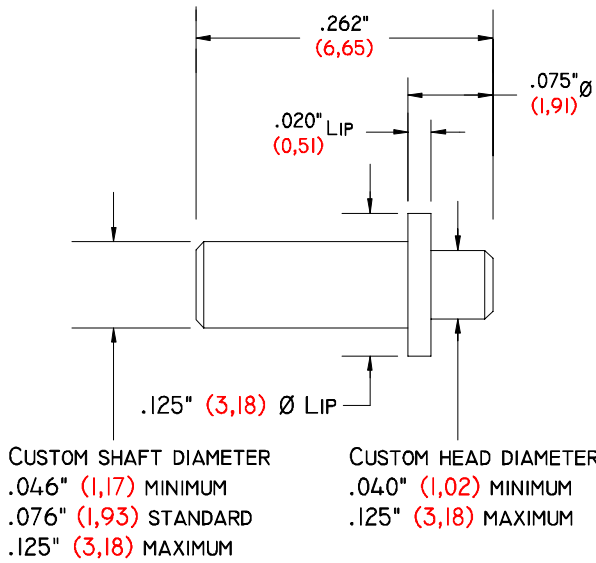

CUSTOM SHAFT DIAMETER  
.046" (1,17) MINIMUM  
.076" (1,93) STANDARD  
.125" (3,18) MAXIMUM

CUSTOM HEAD DIAMETER  
.040" (1,02) MINIMUM  
.125" (3,18) MAXIMUM

USE LIP STYLE TOOLING PINS WHEN THE HEAD DIAMETER IS SMALLER THAN BODY DIAMETER. THE LIP WILL KEEP THE TOOLING PIN FROM PUSHING THROUGH THE FIXTURE.

TO ORDER, DEVELOP A PART NUMBER USING THE CUSTOM HEAD DIAMETER, & CUSTOM SHAFT DIAMETER REQUIRED USING THE MINIMUM / MAXIMUM INFORMATION IN THE ILLUSTRATION ABOVE.

MATERIAL: STAINLESS STEEL.

EXAMPLE:

GI- 262 - 062 - 076 BTP / L

HEAD DIAMETER      SHAFT DIAMETER

### CUSTOM OVER ALL LENGTH

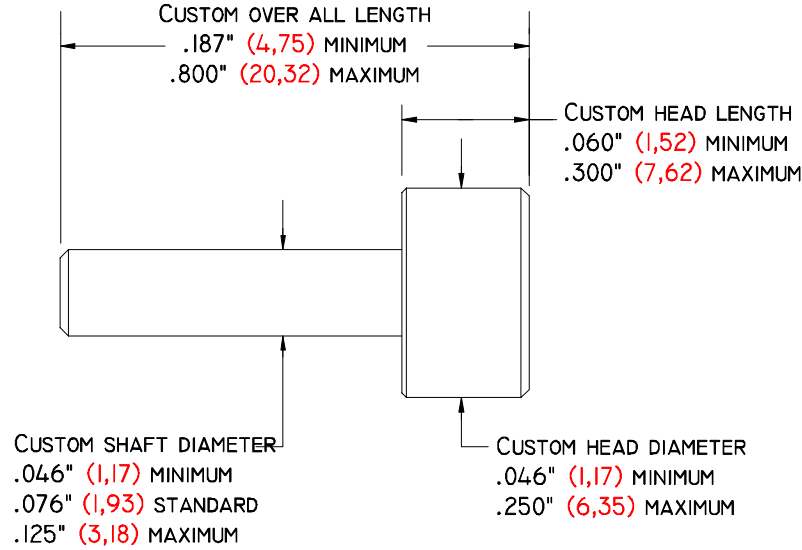

CUSTOM SHAFT DIAMETER  
.046" (1,17) MINIMUM  
.076" (1,93) STANDARD  
.125" (3,18) MAXIMUM

CUSTOM HEAD DIAMETER  
.046" (1,17) MINIMUM  
.250" (6,35) MAXIMUM

TO ORDER, DEVELOP A PART NUMBER USING THE CUSTOM OVER ALL LENGTH CUSTOM HEAD DIAMETER, CUSTOM SHAFT DIAMETER & CUSTOM HEAD LENGTH REQUIRED USING THE MINIMUM / MAXIMUM INFORMATION IN THE ILLUSTRATION ABOVE.

MATERIAL: STAINLESS STEEL.

EXAMPLE:

GI- 400 - 187 - 093 / 075 BTP

OVER ALL LENGTH      HEAD LENGTH  
HEAD DIAMETER      SHAFT DIAMETER