

FIXTURE HARDWARE FOR TTI* TESTERS USING 1.1" (27,94) & 2.02" (51,31) TRANSLATOR PINS

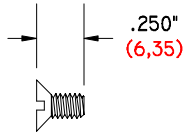

GI-1/4-6-32 FHNS
.250" (6,35) LONG
6-32 THREAD
FLAT HEAD NYLON SCREW

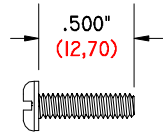

GI-1/2-6-32 PHNS
.500" (12,70) LONG
6-32 THREAD
PAN HEAD NYLON SCREW

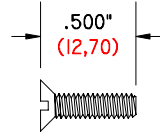

GI-1/2-6-32 FHNS
.500" (12,70) LONG
6-32 THREAD
FLAT HEAD NYLON SCREW

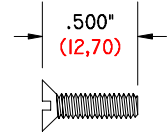

GI-1/2-6-32 FHSS
.500" (12,70) LONG
6-32 THREAD
FLAT HEAD STAINLESS STEEL SCREW

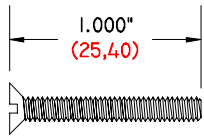

GI-1-6-32 FHSS
1.000" (25,40) LONG
6-32 THREAD
FLAT HEAD STAINLESS STEEL SCREW

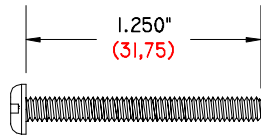

GI-1 1/4-6-32 PHNS
1.250" (31,75) LONG
6-32 THREAD
PAN HEAD NYLON SCREW

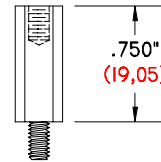

GI-750-250/6-32 MFHS
.750" (19,05) LONG
.250" (6,35) HEXAGON
6-32 THREAD
MALE - FEMALE HEXAGON SPACER

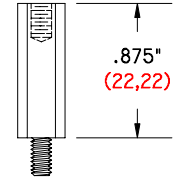

GI-875-250/6-32 MFHS
.875" (22,23) LONG
.250" (6,35) HEXAGON
6-32 THREAD
MALE - FEMALE HEXAGON SPACER

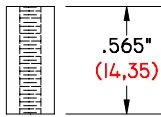

GI-565-250/6-32 DS
.565" (14,35) LONG
.250" (6,35) Ø O. D.
6-32 THREAD
DELRIN SPACER

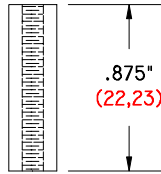

GI-875-250/6-32 DS
.875" (22,23) LONG
.250" (6,35) Ø O. D.
6-32 THREAD
DELRIN SPACER

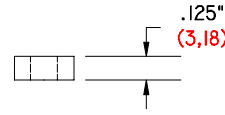

GI-125-312/140 DS
.125" (3,18) LONG
.312" (7,92) Ø O. D.
.140" (3,56) Ø I. D.
DELRIN SPACER

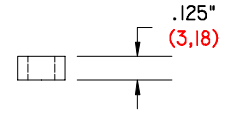

GI-125-250/140 DS
.125" (3,18) LONG
.250" (6,35) Ø O. D.
.140" (3,56) Ø I. D.
DELRIN SPACER

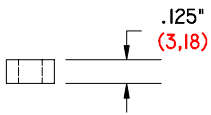

GI-125-250/125 DS
.125" (3,18) LONG
.250" (6,35) Ø O. D.
.125" (3,18) Ø I. D.
DELRIN SPACER

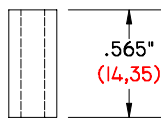

GI-565-250/125 DS
.565" (14,35) LONG
.250" (6,35) Ø O. D.
.125" (3,18) Ø I. D.
DELRIN SPACER

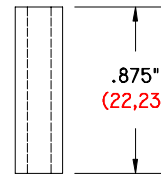

GI-875-250/125 DS
.875" (22,23) LONG
.250" (6,35) Ø O. D.
.125" (3,18) Ø I. D.
DELRIN SPACER

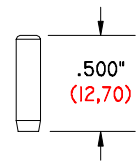

GI-1/2-1/8 DP
.500" (12,70) LONG
.125" (3,18) Ø O. D.
DOWEL PIN

* T T I IS A REGISTERED TRADEMARK OF TEST TECHNOLOGY, INC.