

# 3.75" (95,25) HEADED MUSIC WIRE TRANSLATOR PINS

.032" (0,80) BODY WITH .047" (1,20) TO .250" (6,35) HEAD

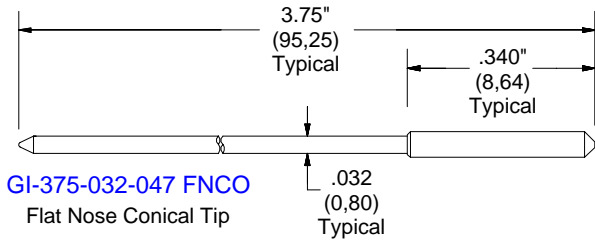

**GI-375-032-047 FNCO**  
 Flat Nose Conical Tip

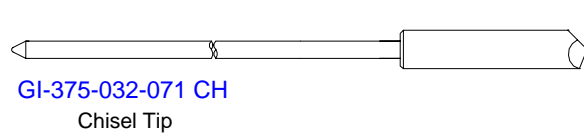

**GI-375-032-071 CH**  
 Chisel Tip

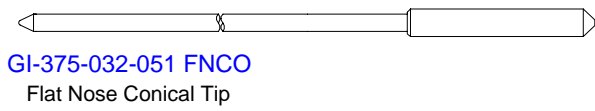

**GI-375-032-051 FNCO**  
 Flat Nose Conical Tip

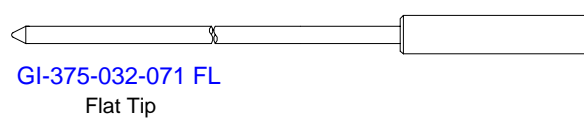

**GI-375-032-071 FL**  
 Flat Tip

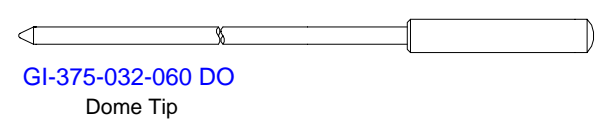

**GI-375-032-060 DO**  
 Dome Tip

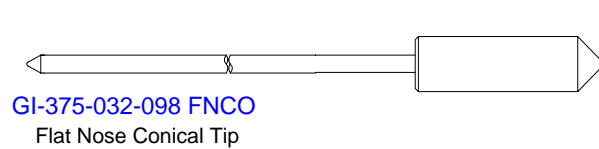

**GI-375-032-098 FNCO**  
 Flat Nose Conical Tip

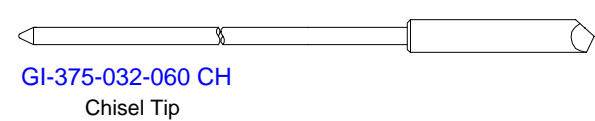
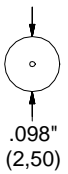

**GI-375-032-060 CH**  
 Chisel Tip

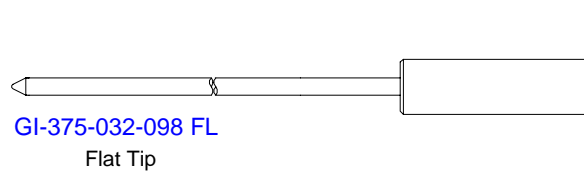

**GI-375-032-098 FL**  
 Flat Tip

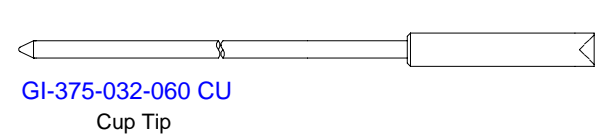
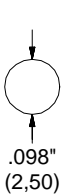

**GI-375-032-060 CU**  
 Cup Tip



**GI-375-032-138 FNCO**  
 Flat Nose Conical Tip

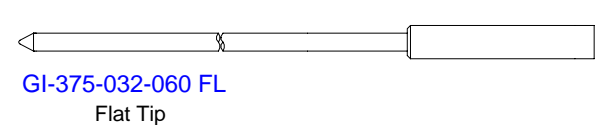

**GI-375-032-060 FL**  
 Flat Tip

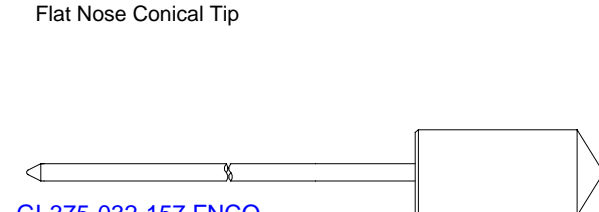

**GI-375-032-157 FNCO**  
 Flat Nose Conical Tip

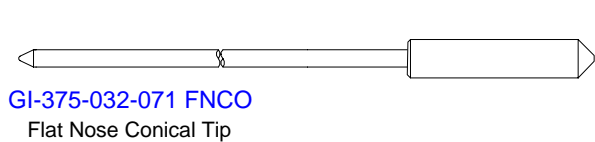
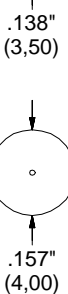

**GI-375-032-071 FNCO**  
 Flat Nose Conical Tip

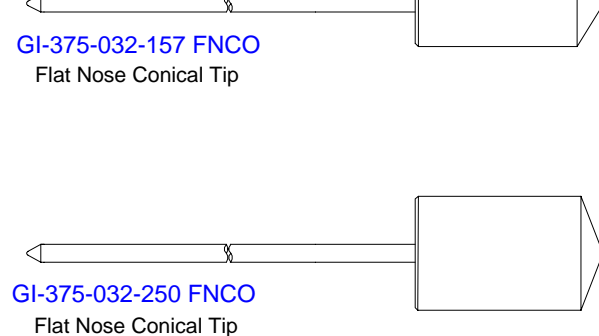
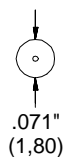

**GI-375-032-250 FNCO**  
 Flat Nose Conical Tip

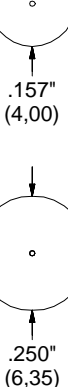

Material: Head- Hardened Beryllium Copper.  
 Body- Music Wire (Spring Steel).

Plating: Head- Gold over Electroless Nickel.  
 Body: Electroless Nickel.

Our Part Numbers Describe The Dimensions Of The Part

Example:

**GI- 375 - 032 - 047 FNCO**

