

2.50" (63,50) HEADED MUSIC WIRE TRANSLATOR PINS

.032" (0,80) BODY WITH .047" (1,20) TO .250" (6,35) HEAD

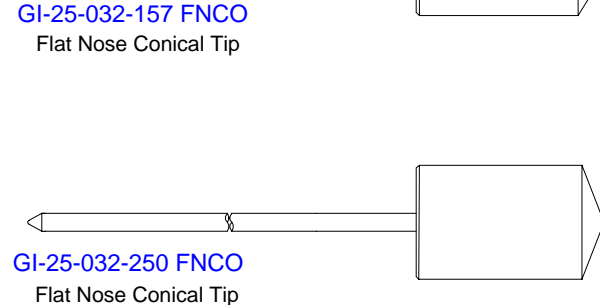
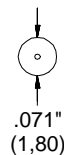
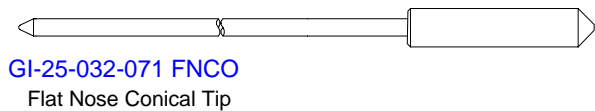
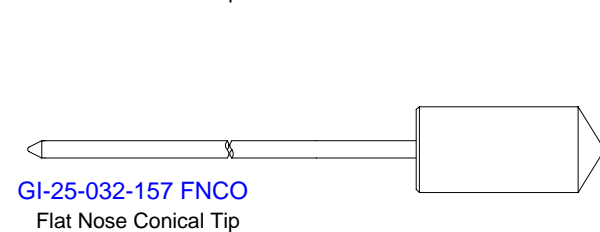
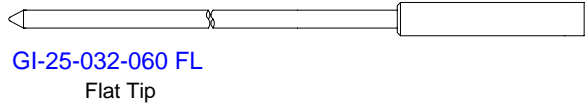
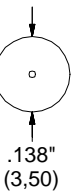
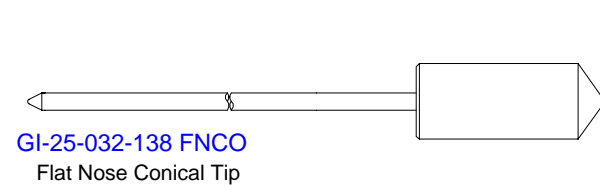
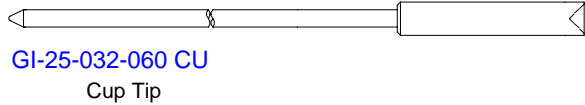
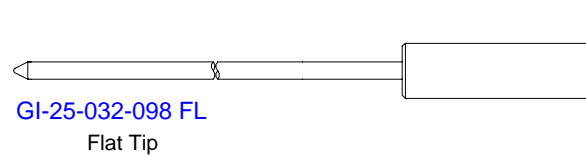
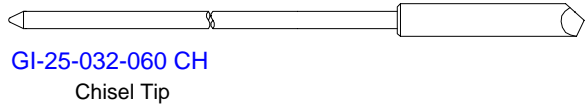
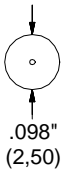
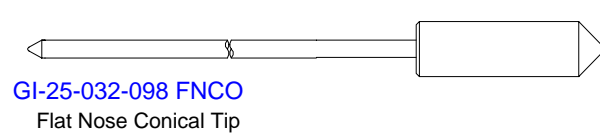
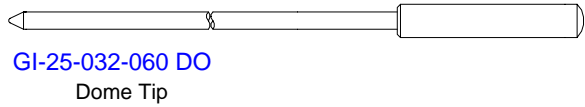
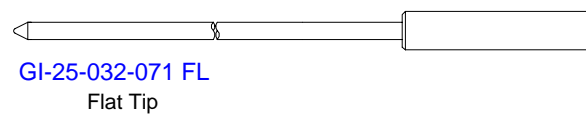
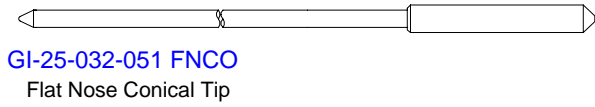
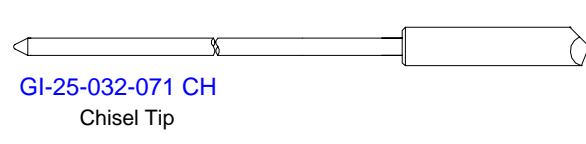
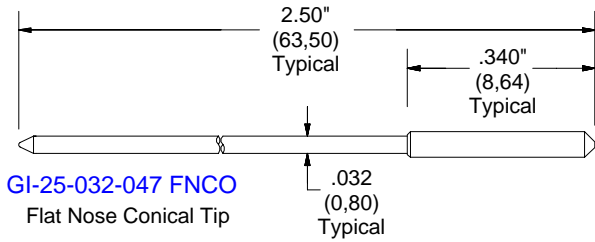

Material: Head- Hardened Beryllium Copper.
 Body- Music Wire (Spring Steel).

Plating: Head- Gold over Electroless Nickel.
 Body: Electroless Nickel.

Our Part Numbers Describe The Dimensions Of The Part

Example:

GI- 25 - 032 - 047 FNCO

